

**SILVER LAKE WATER AND SEWER DISTRICT
SNOHOMISH COUNTY, WASHINGTON**

RESOLUTION NO. 792

**A RESOLUTION OF THE BOARD OF COMMISSIONERS OF SILVER
LAKE WATER AND SEWER DISTRICT, SNOHOMISH COUNTY,
WASHINGTON, ESTABLISHING UNIFORM SEWER SPECIAL
CONNECTION CHARGES FOR THE HIGHLANDS EAST LIFT STATION**

WHEREAS, Silver Lake Water and Sewer District (“District”) owns and operates a public water system and a wastewater collection system pursuant to Title 57 of the Revised Code of Washington located in the Silver Lake area in Snohomish County, Washington; and

WHEREAS, a sewer lift station referred to as the Highlands East Lift Station (“Lift Station”) was previously constructed to make District sewer service available to the surrounding area, and the ownership of the Lift Station was conveyed to the District and is a part of the District’s wastewater collection and transmission system; and

WHEREAS, a developer (“Developer”) proposes to subdivide and develop the property (“Property”) depicted on **Exhibit “A”** into approximately 115 individual lots that will be connected to the District’s wastewater system. The development project is known as Glacier View Estates and shall be a land use action approved by Snohomish County; and

WHEREAS, the Property was included in the adopted Wastewater Comprehensive Plan to be served by the existing Sector 7 Lift Station. However, the Developer is unable to procure the easement rights necessary to meet the intent of the Comprehensive Plan. The District and the Developer agree that the Property would be best served alternately by the existing Highlands East Lift Station; and

WHEREAS, the Highlands East Lift Station requires various improvements and upgrades to fully serve the existing and new connections in the regional service area in the future. The scope and estimated cost of those improvements is shown in **Exhibit “B”**. The District and the Developer agree that the cost of those future improvements should be shared proportionately based on the total number of connections; and

WHEREAS, RCW 57.08.005 (11) authorizes the District to charge property owners seeking to connect to the District’s sewer system, as a condition to granting the right to so connect. Such reasonable connection charges as the District’s Board of Commissioners shall determine to be proper, in order that such property owners shall bear their equitable share of the cost of such system; and

WHEREAS, District staff have recommended the District adopt a Special Sewer Connection Charge for the Highlands East Lift Station improvements as shown in **Exhibit “A”** for the owners of the Property seeking to connect and use the portion of the District’s sewer system which will utilize the existing capacity of the Highlands East Lift Station; and

BE IT RESOLVED by the Board of Commissioners of the Silver Lake Water and Sewer District of Snohomish County, Washington, as follows:

1. **Definitions:** The terms set forth herein are defined in Title 9 of the District Code for rates and charges for new water and sewer connections and such terms may be subsequently be modified and amended.

2. **Special Connection Charge:** A Special Sewer Connection Charge of One Thousand Four Hundred Seventy Dollars and 55/100 (\$1,470.55) per ERU to be connected to the District's sewer system, is hereby adopted and shall be assessed against owners of the Property, or subsequently subdivided lots as part of an approved land use action, that connect to or use the capacity of the Highlands East Lift Station.

The Special Connection Charge shall be adjusted proportionately for any change in the final total number of connections. The Highlands East Special Connection Charge shall be paid to the District for each developed lot at the time a Side Sewer Permit is approved by the District.

3. **Existing Sector 7 Connection Charge:** Any portion or subdivided lot of Property that connects to or uses the Highlands East Lift Station and are subject to the Special Connection Charge established in Section 2 above, shall be exempt from any existing Sector 7 Lift Station charges established by Resolution No. 758.

4. **Recorded Notice:** Notice of the adoption of the Special Sewer Connection Charge referenced in Section 2 above, shall be recorded with the Snohomish County Auditor's Office together with the attached **Exhibit "A"**, describing the real property to which such special connection charges apply.

5. **Effective Date:** This Resolution shall be effective the date of its adoption set forth below.

6. **Other District and Agency Fees and Charges:** Any charges owing as established by this Resolution, by any party seeking to connect to the District's sewer system, shall be in addition to any and all other District sewer fees and charges, connection or otherwise, as established by District resolution, policy or procedure, and such sewer fees and charges of other governmental agencies such as Snohomish County.

Adopted by the Board of Commissioners of Silver Lake Water and Sewer District, Snohomish County, Washington, at the regular open public meeting thereof, held the 13th day of February, 2020.

**BOARD OF COMMISSIONERS
SILVER LAKE WATER AND SEWER**



President and Commissioner



Secretary and Commissioner

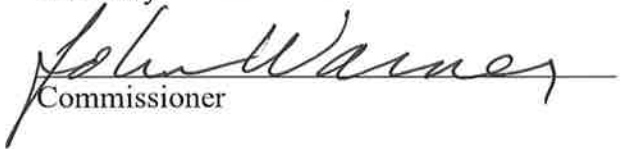

Commissioner

CERTIFICATION

I, the undersigned, Secretary of the Board of Commissioners of Silver Lake Water and Sewer District, Snohomish County, Washington (the "District"), hereby certify as follows:

1. The attached copy of Resolution No. 792 (the "Resolution") is a full, true and correct copy of the Resolution duly adopted at a regular meeting of the Board of Commissioners of the District, held at the regular meeting place thereof on February 13, 2020, as that Resolution appears on the minute book of the District; and the Resolution will be in full force and effect immediately following its adoption; and

2. A quorum of the members of the Board of Commissioners was present throughout the meeting and a majority of those members present voted in the proper manner for the adoption of the Resolution.

IN WITNESS WHEREOF, I have hereunto set my hand this 13th day of February, 2020.

**SILVER LAKE WATER AND SEWER DISTRICT,
SNOHOMISH COUNTY, WASHINGTON**



Shauna Willner, Secretary

EXHIBIT "A"
Glacier View Estates Special Connection Charge Area Map

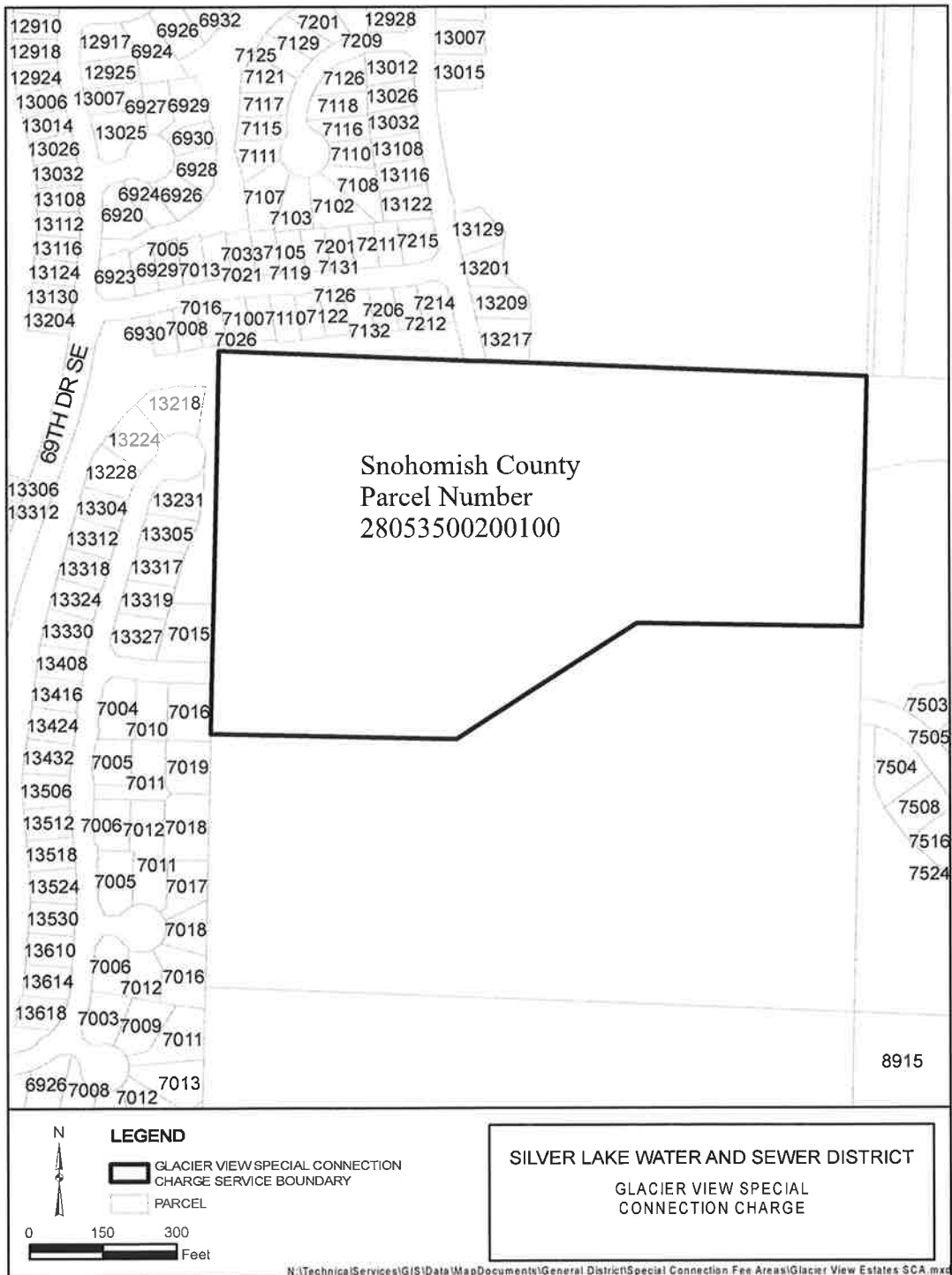

**SILVER LAKE WATER & SEWER DISTRICT
PRELIMINARY PROJECT COST ESTIMATE
HIGHLANDS EAST LIFT STATION IMPROVEMENTS
February 2020**

Cost per ERU*	\$ 1,470.55
---------------	-------------

*Cost per ERU shall be adjusted appropriately for an increase or decrease in the number of connections